

# **DOROTHY HAMM MIDDLE SCHOOL**



# WHO IS DOROTHY HAMM?

- Schools were segregated until 1959
- Civil Rights activist from Halls Hill, Arlington
- In 1950's she participated in a civil action suit for her son and other kids to integrate Arlington Public Schools
- Our building - first school to integrate in Virginia



# OUR MASCOT



- You are joining the Phoenix family!!!
- Our colors are **GOLD**, **BLACK** & **RED**
- Fun facts about the Phoenix:
  - Only one Phoenix can exist at a time
  - The Phoenix lives for 500 years or more
  - After death, the Phoenix **RISEs** from the ashes as a new Phoenix



Respect  
Integrity,  
Self-Awareness,  
Engagement

# People to Know



*from left to right*

- **Ms. Ferguson**  
Director of Counseling
- **Ms. L. Moore**  
Assistant Principal
- **Ms. E. Smith**  
Principal
- **Ms. C. Moore**  
Assistant Principal
- **Ms. Johnson**  
Assistant Principal



# Rising 6th Grade Counselor

## Mr. Tuttle's fun facts

- Next year will be my 6th year at DHMS
- Married with one child (age 14) and a black lab named Maddie
- Not the only "Tuttle" at DHMS
- Master on a sewing machine

## Mr. Tuttle's favorites

- Sailing
- Go Philly
- Viva Barca

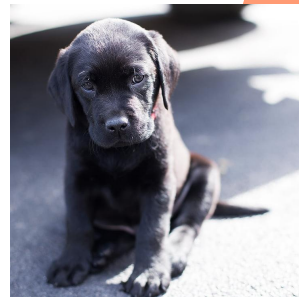

# 6TH GRADE SCHEDULE

- School starts at 7:50 and ends at 2:35
- 6th graders have their own schedule, and do not attend classes in groups.
- 6th grader's typical schedule:
  - 1st/2nd Period: Core Classes
  - 3rd/4th Period: Core Class
  - 5th Period (everyday class): Core Classes
  - Lunch & Phoenix Time
  - 6th/7th Period: Elective Classes
- 6th graders all eat lunch together at the same time in the cafeteria



# CLASSES

6th grade students have 5 core classes:

- **American History** (Regular or Intensified)
- **English** (Regular or Intensified)
- **Science** (Regular or Intensified)
- **Math**
- **Reading** (now called Disciplinary Literacy. It sound bad, but it is just the Reading class)

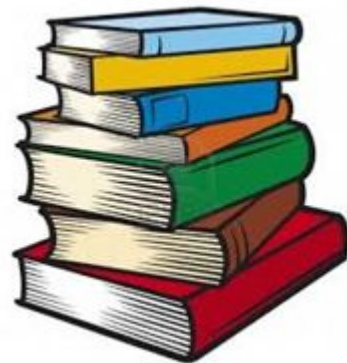

# Course Options for 6th Graders

## English 6, Intensified

English 6 Intensified is a core course that provides a rigorous study of English Language Arts content and is open to all MS students. This course provides opportunities for students to focus on reading, writing, speaking, and listening as indicated by the Grade 6 Virginia Standards of Learning. Students will apply a **complex lens of examination and interpretation** to a variety of texts and genres to include fiction, non-fiction, short stories, novels and excerpts, and media. Students will also be tasked with reflecting on their thinking and learning and use the writing process to develop and craft expository, narrative, and persuasive writing pieces.

## Grade 6 Science, Intensified

Students will engage in **extended application and analysis** designed to deepen understanding of content based on increased ability to extrapolate information from novel concepts, employ the use of mathematical analysis, and engage in more intensive reading and writing opportunities. Students will use **abstract, critical thinking approaches through inquiry-based projects** focusing on the nature of science and the use of science and engineering skills as indicated by the Grade 6 Virginia Standards of Learning.

## US History to Present, Intensified

Students will **engage in extended application and analysis** of United States history through a thematic lens across time and place. Students will develop **critical thinking approaches through inquiry-based projects** focusing on historical thinking skills and the use of primary and secondary accounts to formulate a deeper understanding of the past.



# ELECTIVES AND PE



- All students take Health & PE
- Elective Choice
  - Music (band, chorus or orchestra)
- OR
- Exploratory Wheel



# EXPLORATORY WHEEL ROTATION

Exploratory classes will rotate throughout the year and may include 5 of the following classes:

**Visual Arts**

**Technical Education**

**Theatre Arts**

**Computer Keyboarding**

**World Languages**

**Introduction to Music**



Electives



*\*band and orchestra are not offered in the wheel*

# How to Choose your Elective!

- Your elementary school counselor will give you a code to join my canvas course: **DHMS Class of 2031**
- In the canvas course, there will be a google link to complete the Course Request Form (CRF) **with your parents**
- Please complete the form by: Friday, **February 23rd**



### Rising 6th Grade Course Request Form (CRF)

This Course Request Form (CRF) allows a student and their family to make course selections for the following year. All Grade 6 students are required to take the following core courses: English, Math, Science, Social Studies, Reading, and Health & Physical Education. Additional core courses may also be required based upon the specific program in which the student is enrolled.

Descriptions of all courses can be found in the Middle School Program of Studies for 2023-2024:  
<https://www.apsva.us/instruction/curriculum-instruction/program-of-studies/>

The email address below is your Parent's or Guardian's email address

Elective Choice \*

☐ Expository Rotation

☐ Band (woodwinds, brass and percussion)

☐ Orchestra

☐ Chorus

Please choose the level of English \*

☐ English 6

☐ English 6 Intensified

Please choose the level of History \*

☐ US History

☐ US History Intensified

Please choose the level of Science \*

☐ Science 6

☐ Science 6 Intensified

# Lockers

- You will have your own locker accessible to you the entire day
- You will also receive a combination lock, and a video tutorial for how to use it
- Your locker is the best place to leave things that you don't use during the school day...**including your cell phone.**

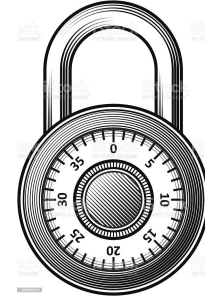



# AFTER SCHOOL OPTIONS

- The school day ends at 2:35pm
- Monday, Tuesday and Thursday After School Periods (ASP)
  - ASP 1: 2:40 - 3:30pm
  - ASP 2: 3:30 - 4:10pm
- A late bus is provided on these days



# CURRENT CLUBS AT DHMS

- Homework Club
- Act II: Choir & Jazz Band
- Something About Food Club
- Math Counts
- Girls on the Run
- D&D Club
- Robotics Club
- Coding Club
- DHMS Newspaper Club
- Investment Club
- Environmental Club

- Teen Advisory Board (TAB)
- Board Game Club
- Technology Student Association (TSA)
- Art Club
- Chess Club
- Model UN
- Phoenix Bikes
- International Club
- Student Council Association (SCA)
- Green Team



# SPORTS AT DHMS

## Intramurals:

- Do not require a physical
- Drop in, no tryouts

## Interscholastic:

- Students **MUST** have a current physical on file with the Activities Coordinator (dated after May 1, 2024)
- Most sports require tryouts



- DHMS sports teams are open to 6th, 7th, and 8th graders. Students from all three grades compete together.
- DHMS students have the opportunity to try out for high school sports that we do not offer in 8th grade. (ex. Football, baseball)

# SPORTS AT DHMS

## **Fall** (September – December)

Boys & Girls Soccer\*

Tennis\*

Ultimate Frisbee

Girls Basketball\*

Cheerleading\*

## **Winter** (January – April)

Boys Basketball\*

Wrestling

Swim/Dive

Cheerleading\*

## **Spring** (March – May)

Track and Field

*\* These teams have limited roster spots  
and typically require a “tryout.”*





# After School at DHMS



Follow us on Twitter: **DHMS\_Activities** and Instagram: **phoenix\_activities**

Visit the school website for more information: [dorothyhamm.apsva.us/sports/](http://dorothyhamm.apsva.us/sports/)



# Tour the Building

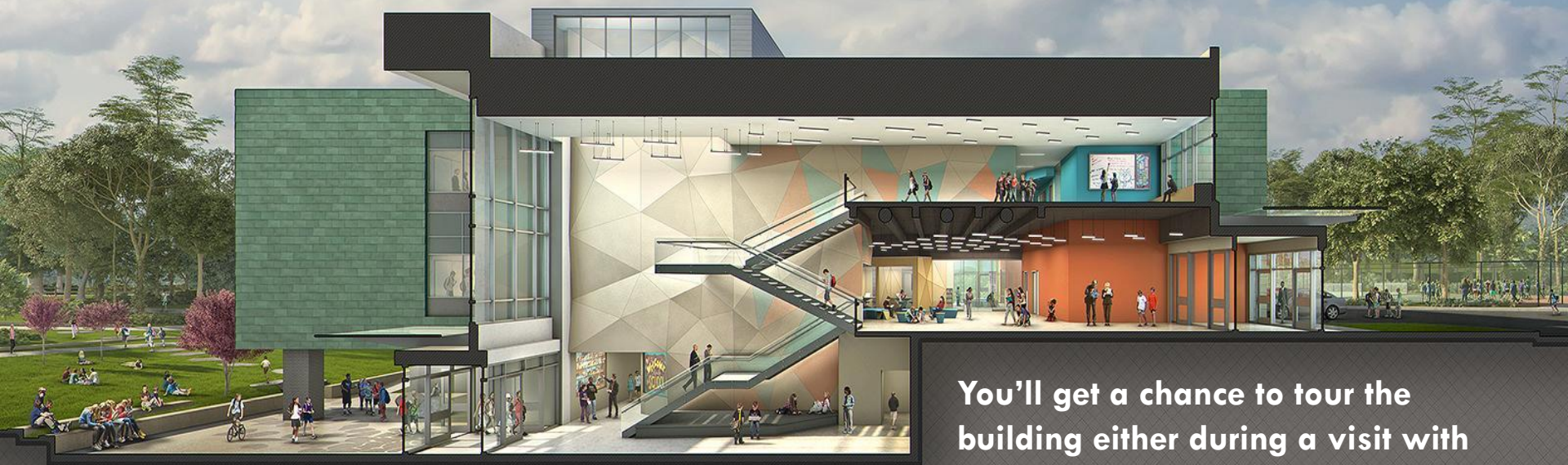

**You'll get a chance to tour the building either during a visit with your elementary school or over the summer!**





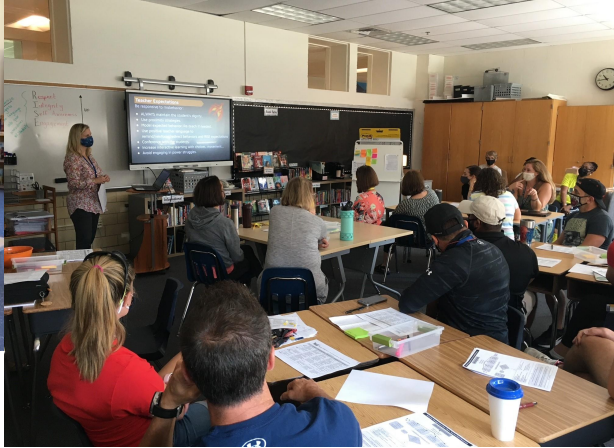



**Lorcom Lane**

**Vacation Lane**

**DHMS Plaza**

**The Driveway -  
Kiss and Drop!**

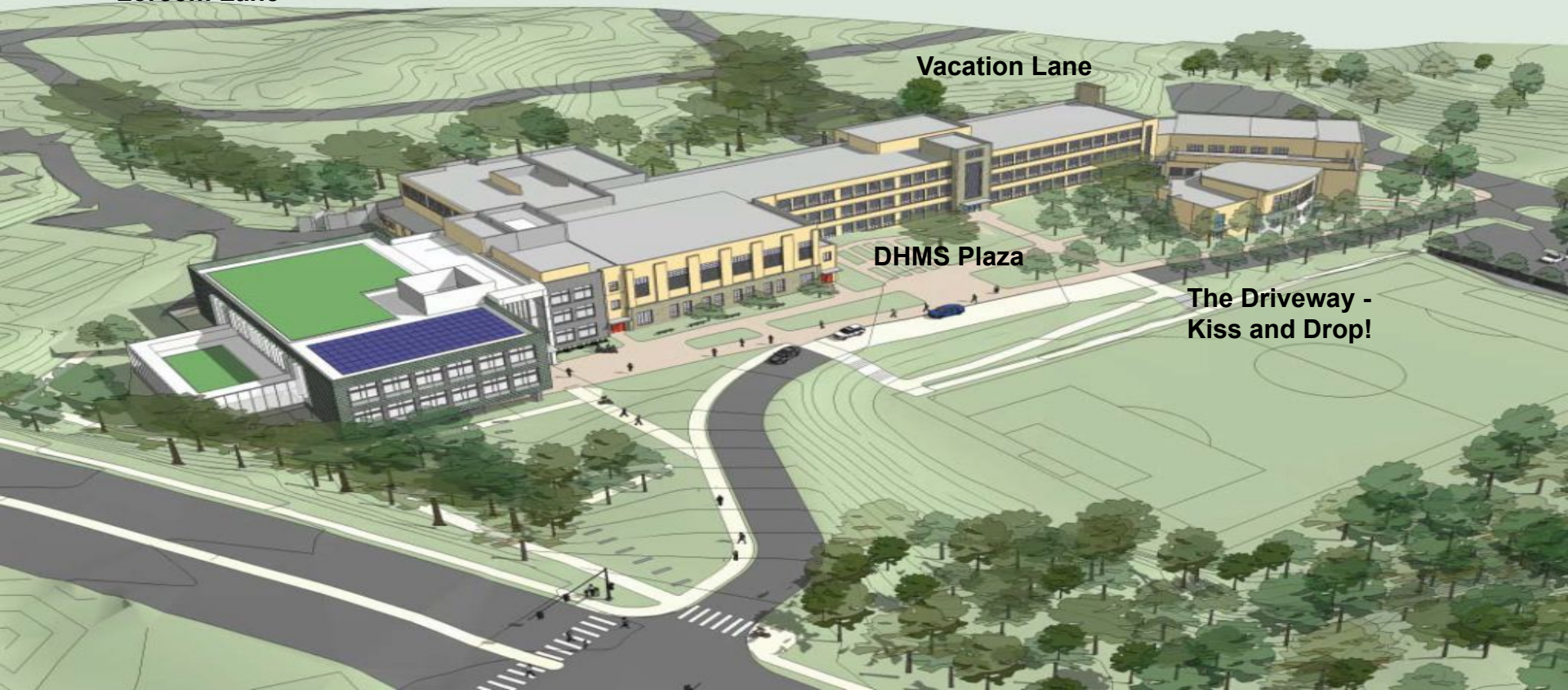

## Arlington Public Schools Middle School Mathematics Progression, SY 2024 - 2025

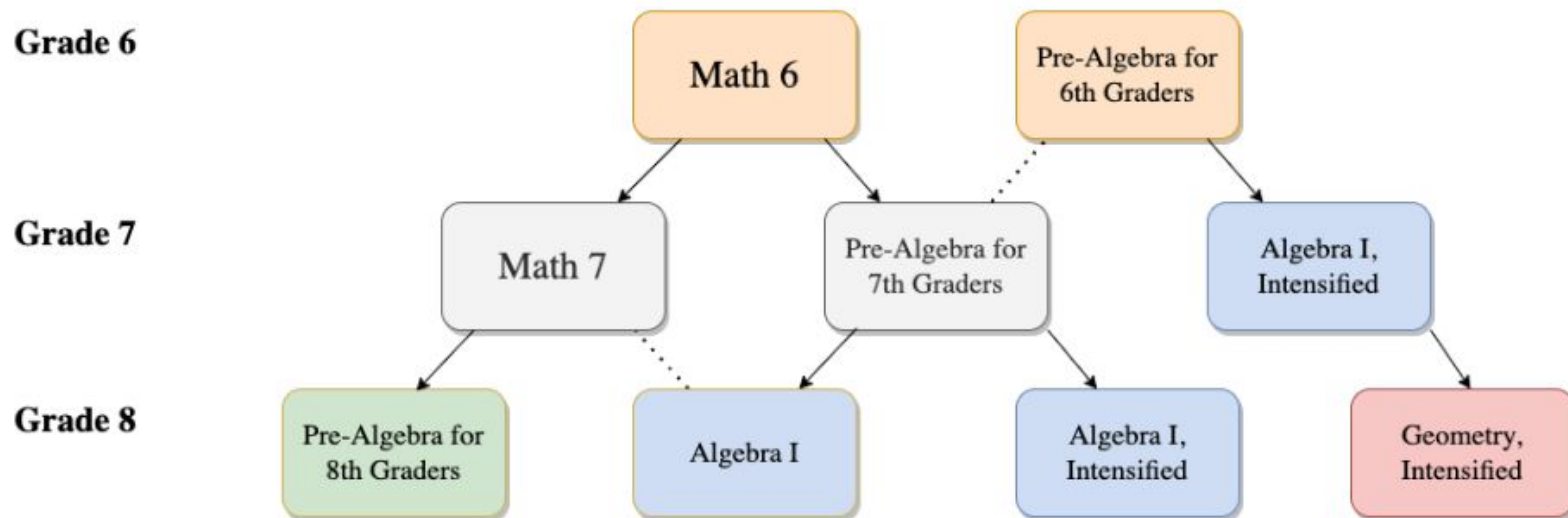

- Students needing additional support may be concurrently enrolled in Math 6, Math 7, or Pre-Algebra 8 along with an associated Strategies course.

## Arlington Public Schools High School Mathematics Progression, SY 2024 - 2025

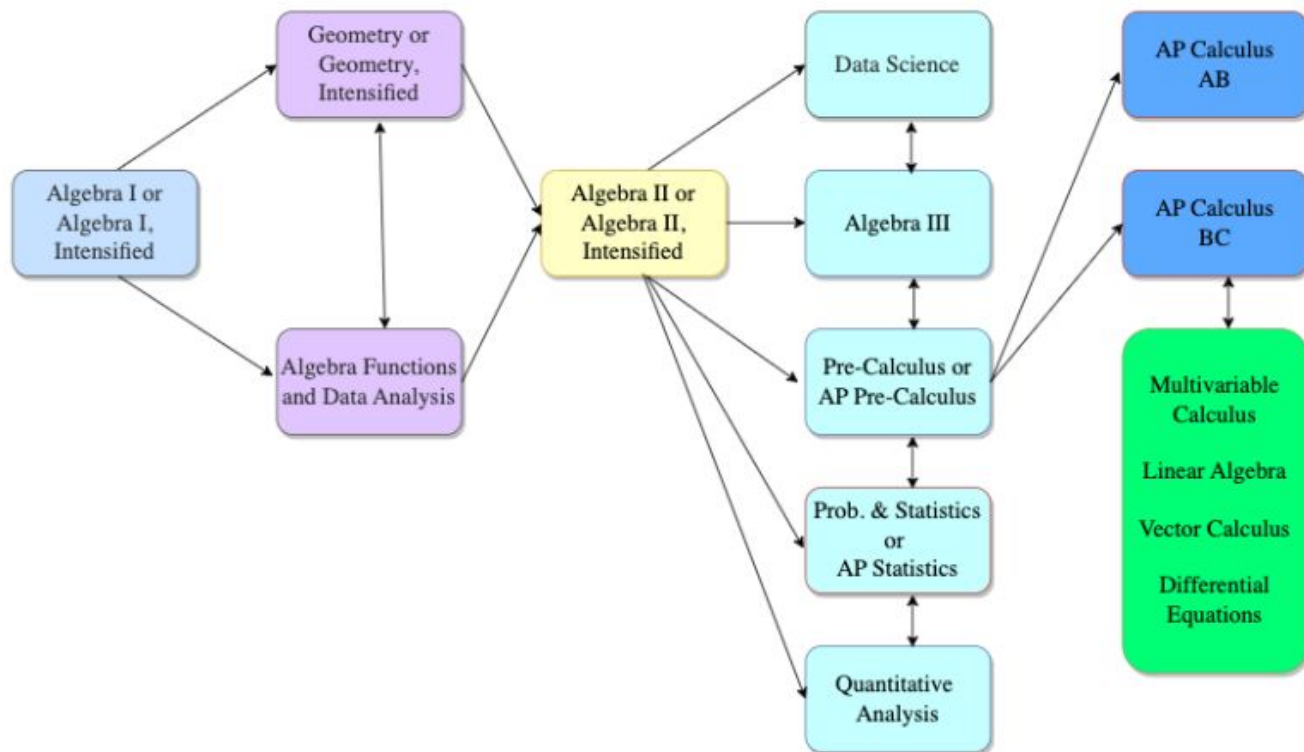

### Considerations:

- For specific IB and Dual Enrollment courses not mentioned on this diagram, please see the index of courses offered at individual high schools.
- Students needing additional support may be concurrently enrolled in Algebra I, Geometry, or Algebra II along with an associated Strategies course.

**Don't forget your course  
request form (CRF) is due  
Friday, February 23rd!**



# Any questions?



- Don't forget to check out the DHMS homepage and DHMS Class of 2030 canvas page for information and updates

We can't wait to see you in the fall!

